

## QUICK START GUIDE

# Server Express® Pump

Tips and tricks to help you get started with your new Server Express® pump.

**1**

Remove unit from box. Wash, rinse, sanitize, and air dry pump parts properly before use.



**2**

Squeeze pinch valve open to ensure it isn't stuck shut, then insert into pump housing.

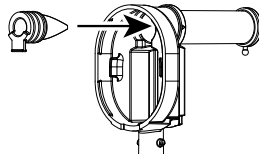

**3**

Press dome into housing fully and wrap loop around lower opening to secure.

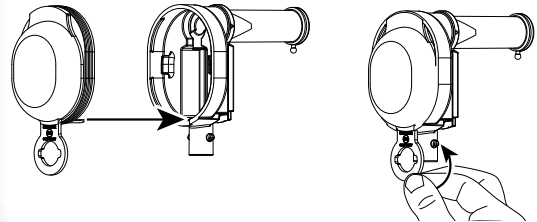

**4**

Lubricate with a small amount of clean water and install tube by rotating until both pegs on housing fit into holes on tube.

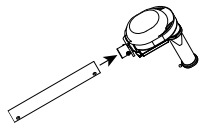

**5**

Lubricate with water and install connector by rotating until both pegs on connector fit into holes on tube.

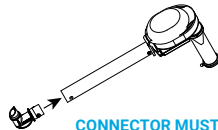

CONNECTOR MUST POINT AWAY FROM END OF DISCHARGE TUBE.

**6**

Insert discharge fitting into discharge tube. Place loop of fitting around peg on end of discharge tube.

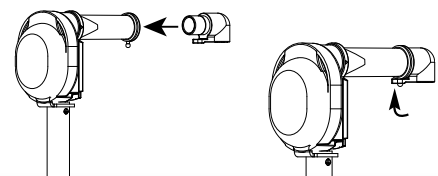

**7**

Fully assembled pump.

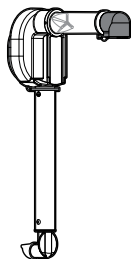

## WANT TO LEARN MORE?

Visit [server-products.com/manual-more](https://server-products.com/manual-more) for your manual, part breakdown, support videos and more.

[spsales@server-products.com](mailto:spsales@server-products.com) | 800.558.8722

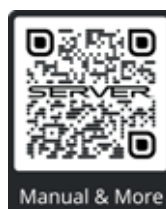

Manual & More

MODEL  
XXXX  
P/N  
#####



SERIES  
##X ##X

**2** YEAR  
WARRANTY

REFERENCE YOUR PART NUMBER  
(P/N) LOCATED ON THE LID OR BASE.