

QUICK START GUIDE

Server Express® Pump

Tips and tricks to help you get started with your new Server Express® pump.

- 1** Remove unit from box. Wash, rinse, sanitize, and air dry pump parts properly before use.



- 2** Squeeze pinch valve open to ensure it isn't stuck shut, then insert into pump housing.

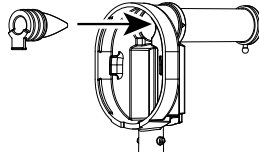

- 3** Press dome into housing fully and wrap loop around lower opening to secure.

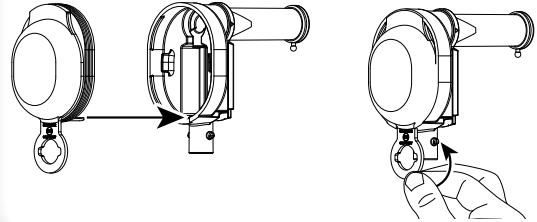

- 4** Lubricate with a small amount of clean water and install tube by rotating until both pegs on housing fit into holes on tube.

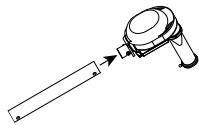

- 5** Lubricate with water and install connector by rotating until both pegs on connector fit into holes on tube.

FOR 1½ GALLON POUCH:
USE 16MM CONNECTOR

FOR 3 GALLON POUCH:
USE 38MM CONNECTOR

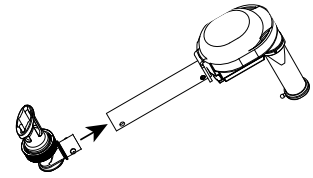

CONNECTOR MUST POINT AWAY FROM END OF DISCHARGE TUBE.

- 6** Insert discharge fitting into discharge tube. Place loop of fitting around peg on end of discharge tube.

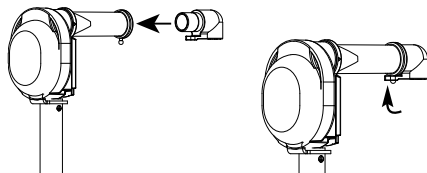

- 7** Fully assembled pump.

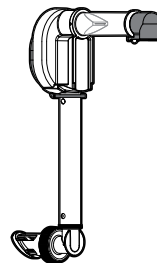

WANT TO LEARN MORE?

Visit server-products.com/manual-more for your manual, part breakdown, support videos and more.

spsales@server-products.com | 800.558.8722

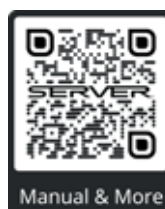

Manual & More

MODEL
XXXX
P/N
#####



SERIES
##X ##X

2 YEAR
WARRANTY

REFERENCE YOUR PART NUMBER
(P/N) LOCATED ON THE LID OR BASE.