

TOUCHLESS EXPRESS™ QUICK START GUIDE

TIPS AND TRICKS TO HELP YOU GET STARTED WITH YOUR NEW TOUCHLESS EXPRESS UNIT.

Wash all parts properly before use.

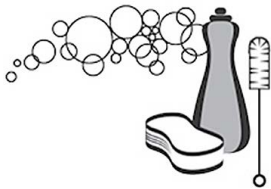

Squeeze pinch valve open to ensure it isn't stuck shut then insert into pump housing.

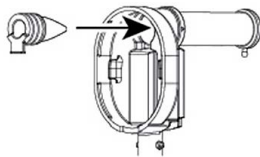

3 Press dome into housing fully and wrap loop around lower opening to secure.

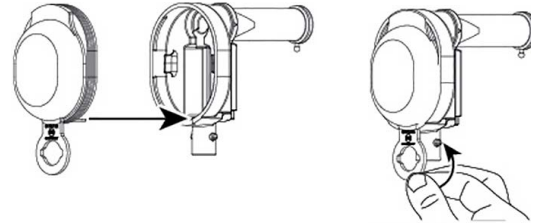

4 Install tube by rotating until both pegs on housing fit into holes on tube.

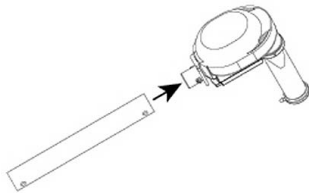

5 Install connector by rotating until both pegs on connector fit into holes on tube.

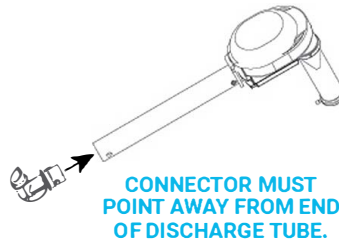

6 Select discharge fitting based on product consistency and insert into discharge tube. Place loop of fitting around peg on end of discharge tube to secure.

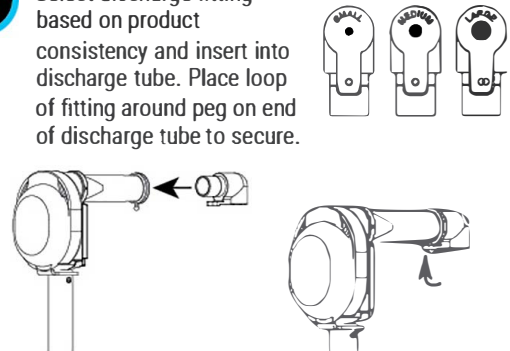

7 Firmly press piercing connector into center of pouch fitment.

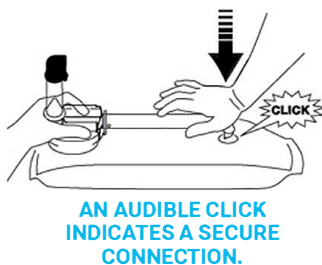

8 Slide pouch and pump into shroud.

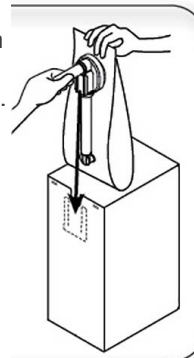

9 Put lid on shroud by matching lid slots with shroud tabs. Pull out locking pin to slide the lid into position and release to lock.

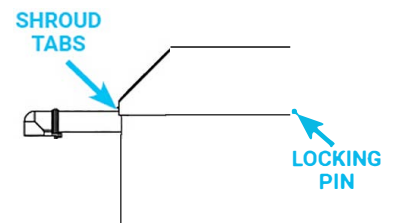

Plug cord into power outlet and press switch on.

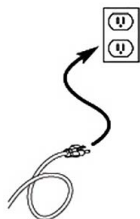

When starting the unit, it will cycle through three light colors (red, blue & green). Light will show blue when the unit is at rest and ready to go.



CONSULT YOUR MANUAL FOR MORE TROUBLESHOOTING INFORMATION.

12 To prime pump or dispense manually, press area below sensor window. Hold hand over sensor window for touchless operation and start dispensing!

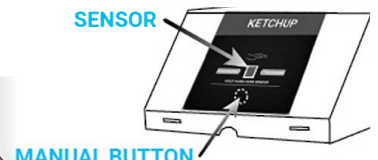

WANT TO LEARN MORE?

Consult your manual or visit [YouTube.com/ServerProducts](https://www.youtube.com/ServerProducts) for more videos.

spsales@server-products.com | 800.558.8722

