

# EXPRESS™ DIRECT-POUR QUICK START GUIDE

## TIPS AND TRICKS TO HELP YOU GET STARTED WITH YOUR NEW DIRECT-POUR EXPRESS UNIT.

- 1** Remove unit from box and wash all parts properly before use.



- 2** Squeeze pinch valve open to ensure it isn't stuck shut and insert into pump housing.

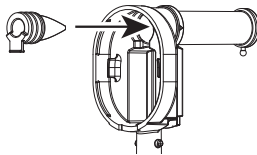

- 3** Press dome into housing fully and wrap loop around lower opening to secure.

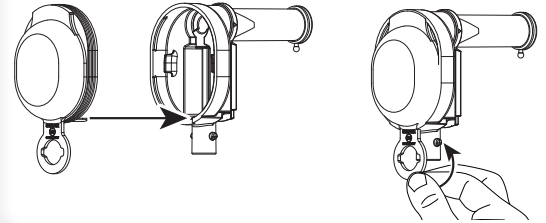

- 4** Install tube by rotating until both pegs on housing fit into holes on tube.

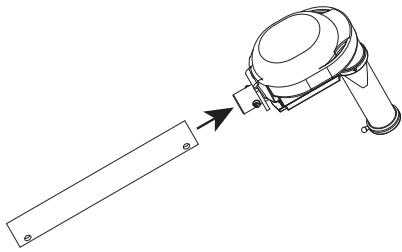

- 5** Select discharge fitting based on product consistency and insert into discharge tube. Place loop of fitting around peg on end of discharge tube to secure.

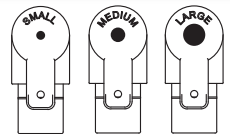
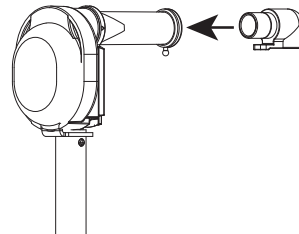

- 6** Fill jar to 1/2-inch below the handle. Put the lid on the jar and slide into shroud through the back slide panel for unit 100236 or through the top of the shroud for unit 100237.

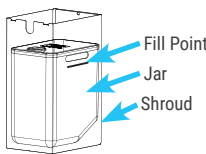

**DO NOT POUR DIRECTLY INTO DISPENSER SHROUD.**

- 7** Place pump into the shroud by aligning pump guides into the slots and the pick-up tube through the hole in the jar lid. Hand-prime pump by pressing dome until product fills discharge tube.

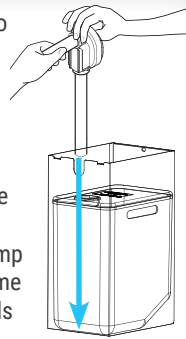

- 8** Adjust portion if necessary. Unit is set to dispense a 1 oz portion. To adjust portion, pull out hinge pin from center roller in the lid and reinstall into desired portion. Pin snaps into place.

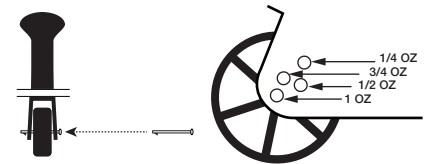

- 9** Place lid on top of shroud.

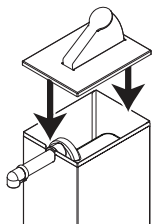

- 10** Press lever to dispense product.

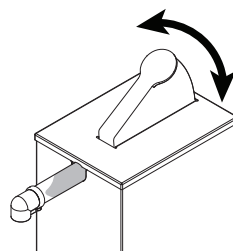

- 11**



Express Direct-Pour Manual

**CONSULT YOUR MANUAL FOR MORE TROUBLESHOOTING INFORMATION.**



### WANT TO LEARN MORE?

Consult your manual or visit [YouTube.com/ServerProducts](https://www.youtube.com/ServerProducts) for more videos.

[spsales@server-products.com](mailto:spsales@server-products.com) | 800.558.8722

**2** YEAR WARRANTY

