

## OLD THERMAL CUT-OUT REMOVAL

- 1 TURN UNIT OFF AND UNPLUG CORD.  
Allow unit to fully cool before proceeding to next step.
- 2 EMPTY ANY CONTENT FROM VESSEL(S).  
Remove all accessories from unit.
- 3 TURN UNIT UPSIDE DOWN, remove four screws from the bottom of base and remove the base.
- 4 TAKE OFF BOTTOM PANEL, by removing four screws and nuts.
- 5 CUT WIRE TIE FROM BUNDLE.
- 6 REMOVE WIRE FROM THERMOSTAT THAT CONNECTS TO SWITCH.
- 7 REMOVE GROUND WIRE FROM VESSEL.
- 8 REMOVE WIRE NUTS WHICH CONNECT HEATING ELEMENT LEADS.
- 9 LIFT OUT VESSEL FROM BASE. Note: The top of the vessels have a silicone bead which will need to be released to remove from base.
- 10 DISCONNECT AND REMOVE THERMAL CUT-OUT, which is located under the aluminum tape.

## NEW THERMAL CUT-OUT INSTALLATION

- 1 CONNECT NEW THERMAL CUT-OUT.
- 2 REPLACE ALUMINUM TAPE, securing the thermal cut-out to vessel.
- 3 PLACE VESSEL BACK INTO BASE.
- 4 ATTACH GROUND WIRE TO VESSEL.
- 5 CONNECT WIRE TO THERMOSTAT.
- 6 SECURE WIRES WITH A WIRE TIE.
- 7 ATTACH BOTTOM PANEL, with four screws and nuts.
- 8 INSTALL BASE TO BOTTOM PANEL, with four screws.

## WIRING DIAGRAM

- 1 Cord Assembly  
A White  
B Black  
C Green
- 2 Bushing, Strain Relief, Right Angle Heyco
- 3 Wire Nut
- 4 Food Vessel, 2 Heating Elements
- 5 Heater Block Assembly
- 6 Ground Screw (Vessel)
- 7 Thermostat
- 8 Thermal Cut-out
- 9 Rocker Switch

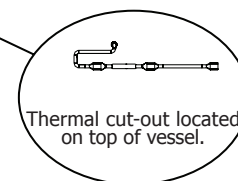
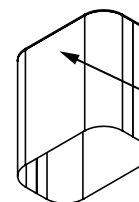
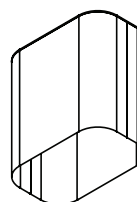
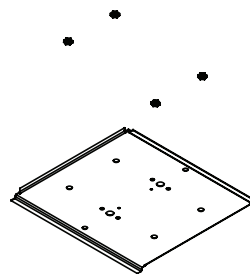
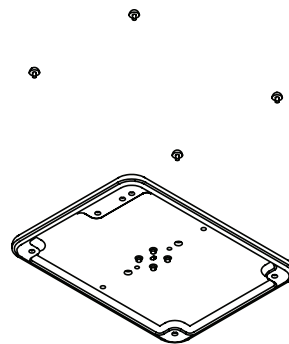
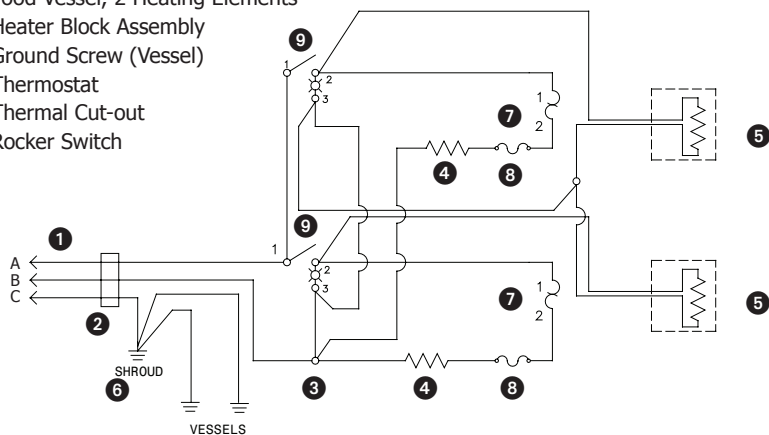

Thermal cut-out located on top of vessel.

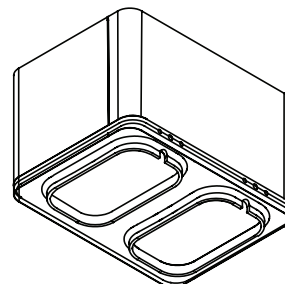

Thermal Cut-Out  
Replacement Kit  
Stock No. 85923  
For Use in EZ Topper Units

### Kit #85923 Includes

| PART# | DESCRIPTION        |
|-------|--------------------|
| 85922 | Aluminum foil tape |
| 85924 | Thermal cut out    |